



TILLOTSON LTD., CLASH INDUSTRIAL ESTATE,
TRALEE, CO. KERRY, IRELAND

PHONE: +353 66 7121911 FAX: +353 66 7124503

e-mail: sales@tillotson.ie



PARTS LIST

Last update: JULY 2000

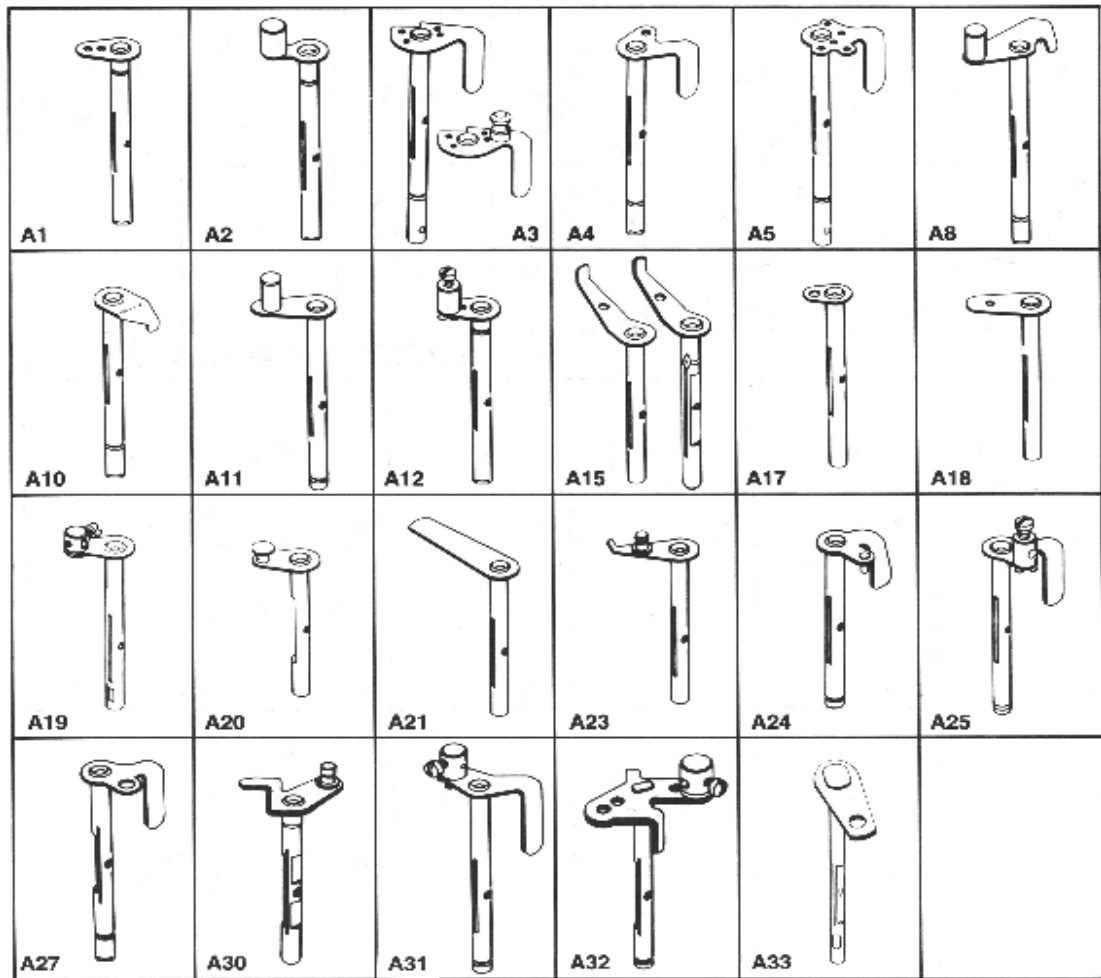
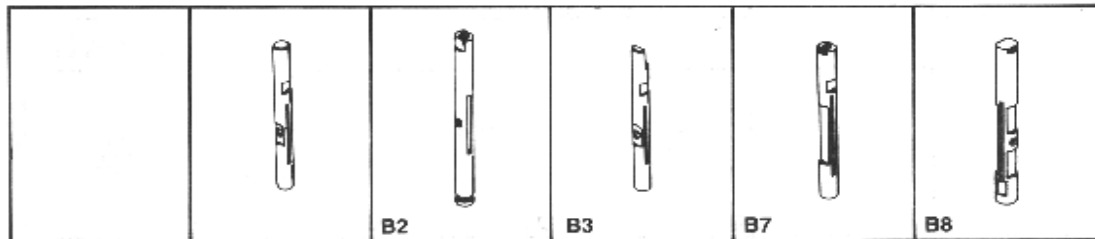
SHAFT & LEVER ASSEMBLIES**SHAFTS**

LEVERS

 C1	 C2	 C3	 C5	 C6	 C7	 C8
 C9	 C12	 C13	 C14	 C15	 C16	

MISCELLANEOUS PARTS

 D1	 D2	 D3	 D4	 D6	 D7
 D9	 D10	 D11	 D12	 D13	 D15
 D16	 D17	 D18	 D19	 D20	 D21
 D22	 D23				

SPRINGS

		 E1	 E2	 E4	 E6
--	--	--------	--------	--------	--------

Illustration of basic parts standard throughout HL series carburettor.
For individual model listing see following pages.

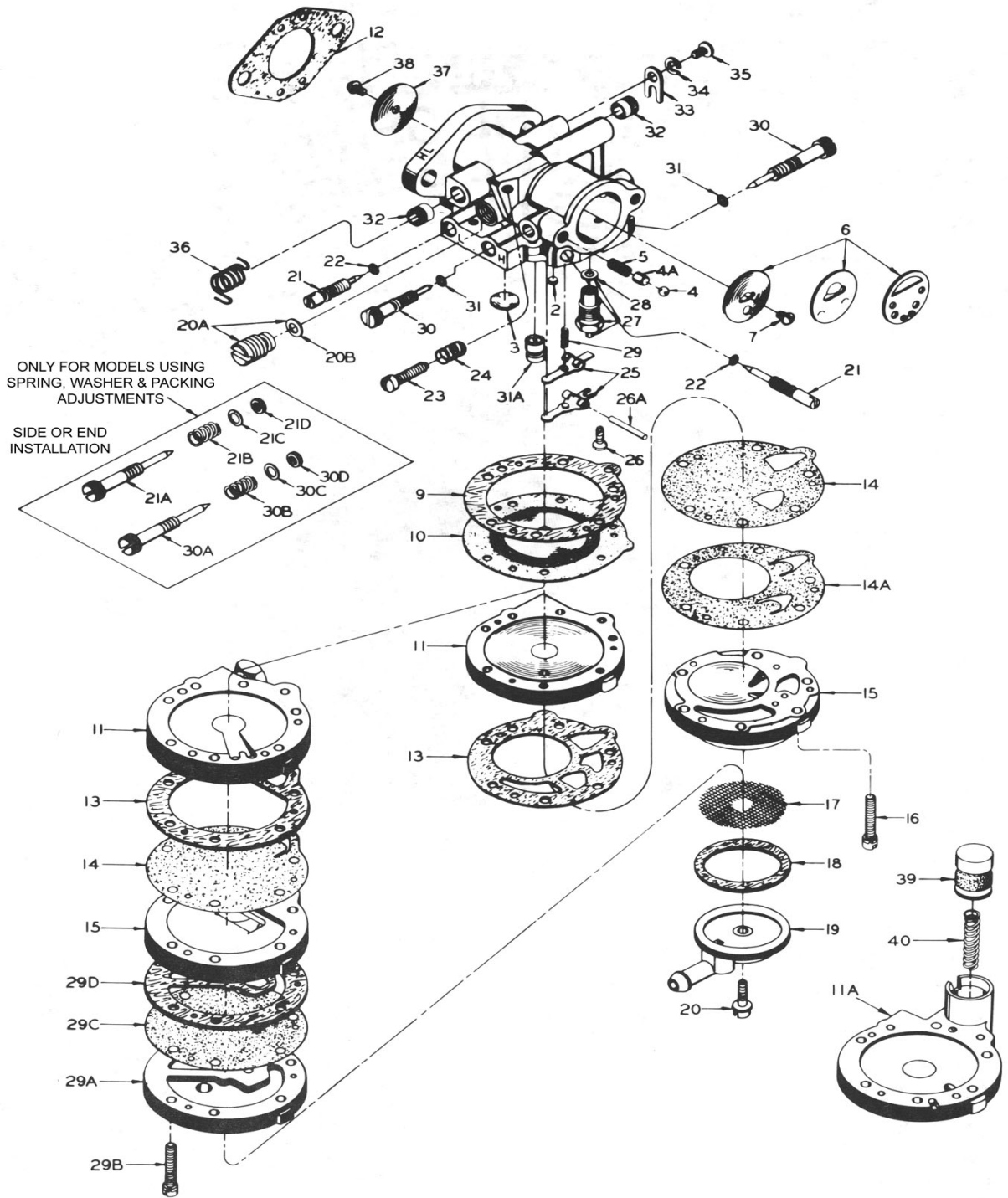

Parts illustrated are typical in appearance and may not look exactly like the part required

Carburetor Model		HL-129E	HL-132H	HL-166B
Customer		Pioneer		Andreas Stihl
Equipment Model No.				
Venturi		11/16"		5/8"
Ref. No.	Part Name			
2	Body Channel Cup Plug	80-332	80-332	
*3	Body Channel Welch Plug	179-55	179-55	179-55
4	Choke Friction Pin	80-317		
5	Choke Friction Spring	24B-281	24B-281	
6	Choke Shutter	27-296	27-368	27-296
7	Choke Shutter Screw	15C-29	15C-29	15C-29
8				
+*9	Diaphragm Gasket	16B-217	16B-217	16B-217
+10	Diaphragm	237-600	237-600	237-600
11	Diaphragm Cover	91A-257	91A-250	91A-250
*12	Flange Gasket	16B-206	16B-206	16B-206
+*13	Fuel Pump Gasket	16B-223	16B-223	16B-223
+*14	Fuel Pump Diaphragm	237-214	237-214	237-214
15	Fuel Pump Body	141-55	141-55	141-55
16	Fuel Pump Body Screw (6)			
17	Fuel Strainer Screen	95-170	95-170	95-170
*18	Fuel Strainer Cover Gasket	16B-205	16B-205	16B-205
19	Fuel Strainer Cover	91A-251	91A-251	91A-251
20	Fuel Strainer Cover Retaining Screw	15B-313	15B-313	15B-313
21	Idle Mixture Screw			
21A	Idle Mixture Screw	43-395	43-388	43-388
21B	Idle Mixture Screw Spring	24B-449	24B-449	24B-449
21C	Idle Mixture Screw Washer	78A-256	78A-256	78A-256
21D	Idle Mixture Screw Packing	44-270	44-270	44-270
22	Idle Mixture Screw Seal Ring			
23	Idle Speed Screw	15C-9	15C-9	15C-9
24	Idle Speed Screw Spring	24B-131	24B-131	24B-131
*25	Inlet Control Lever	155A-23	155A-27	155A-27
26	Inlet Control Lever Fulcrum Screw	15B-329	15B-329	15B-329
26A	Inlet Control Lever Fulcrum Pin	32-79	32-79	32-79
*27	Inlet Needle, Seat & Gasket	233-652	233-703	233-664
28	Inlet Seat Gasket	16B-199	16B-199	16B-199
29	Inlet Tension Spring	24B-289	24B-299	24B-299
30	High Speed Mixture Screw			
30A	High Speed Mixture Screw	43-401	43A-109	43-401
30B	High Speed Mixture Screw Spring	24B-449	24B-449	24B-449
30C	High Speed Mixture Screw Washer	78A-256	78A-256	78A-256
30D	High Speed Mixture Screw Packing	44-270	44-270	44-270
31				
32	Throttle Shaft Bushing (2)			
33	Throttle Shaft Clip	29-218	29-218	29-218
34	Throttle Shaft Clip Lockwasher			
35	Throttle Shaft Clip Ret. Screw	15C-18	15C-18	15C-18
36	Throttle Shaft Return Spring	24B-291		24B-291
37	Throttle Shutter	14-386	14-386	14A-34
38	Throttle Shutter Screw	15C-29		15C-29
A4	Throttle Shaft & Lever	13-1557	13-1592	13-1586
A15	Choke Shaft & Lever	26-949	26-1297	
D20	Body Channel Screen		95-180	
D21	Body Channel Screen Ret. Ring		55A-212	
D3	Fuel Strainer Element		206-121	
B2	Choke Shaft			26-461
	Repair Parts Kit	RK-88HL	RK-92HL	RK-94HL
	Diaphragm & Gasket Set	DG-2HL	DG-2HL	DG-2HL

*Indicates contents of Repair Kit

+Indicates contents of Diaphragm & Gasket Set



HL SERIES

Carburetor Model	HL-189F	HL-227E	HL-229A
Customer			
Equipment Model No.			
Venturi			
Ref. No.	Part Name		
2	Body Channel Cup Plug	80-332	
*3	Body Channel Welch Plug	179-55	179-55
4	Choke Friction Pin		
4A	Choke Friction Pin	80-317	80-317
5	Choke Friction Spring	24B-281	24B-281
6	Choke Shutter		27-309
7	Choke Shutter Screw	27-296	
8			
+*9	Diaphragm Gasket	16B-217	16B-217
+10	Diaphragm	237-600	237-680
11	Diaphragm Cover	91A-250	91-912
*12	Flange Gasket	16B-206	16B-216
+*13	Fuel Pump Gasket	16B-223	16B-223
+*14	Fuel Pump Diaphragm	237-214	237-214
15	Fuel Pump Body	141-55	141-62
16	Fuel Pump Body Screw (6)	15C-51	15C-51
17	Fuel Strainer Screen	95-170	95-170
*18	Fuel Strainer Cover Gasket	16B-205	16B-205
19	Fuel Strainer Cover	91A-251	91A-251
20	Fuel Strainer Cover Retaining Screw	15B-313	15B-313
21	Idle Mixture Screw		
21A	Idle Mixture Screw	43-388	43-388
21B	Idle Mixture Screw Spring	24B-449	24B-449
21C	Idle Mixture Screw Washer	78A-256	78A-256
21D	Idle Mixture Screw Packing	44-270	44-270
22	Idle Mixture Screw Seal Ring		
23	Idle Speed Screw	15C-9	15C-9
24	Idle Speed Screw Spring	24B-131	24B-131
*25	Inlet Control Lever	155A-27	155A-27
26	Inlet Control Lever Fulcrum Screw	15B-329	15B-329
26A	Inlet Control Lever Fulcrum Pin	32-79	32-79
*27	Inlet Needle, Seat & Gasket	233-703	233-665
28	Inlet Seat Gasket	16B-199	16B-199
29	Inlet Tension Spring	24B-299	24B-299
30	High Speed Mixture Screw		
30A	High Speed Mixture Screw	43-401	43-967
30B	High Speed Mixture Screw Spring	24B-449	24B-449
30C	High Speed Mixture Screw Washer	78A-256	78A-256
30D	High Speed Mixture Screw Packing	44-270	44-270
31			
31A	Nozzle Check Valve		363-501
32	Throttle Shaft Bushing (2)		
33	Throttle Shaft Clip	29-218	29-224
34	Throttle Shaft Clip Lockwasher		
35	Throttle Shaft Clip Ret. Screw		
36	Throttle Shaft Return Spring	24B-291	24B-291
37	Throttle Shutter	14-396	14-407
38	Throttle Shutter Screw	15C-29	15C-29
39			
A4	Throttle Shaft & Lever	13-1564	13-1592
A15	Choke Shaft & Lever	26-955	26-977
A32	Throttle Shaft & Lever		13-2034
D17	Fuel Strainer Cover Ret. Screw Gasket	16B-204	78A-248
D20	Body Channel Screen	95-180	
D21	Body Channel Screen Ret. Ring	55A-212	
C9	Throttle Lever		155-671
E6	Throttle Shaft Return Spring		24B-381
	Repair Parts Kit	RK-92HL	RK-102HL
	Diaphragm & Gasket Set	DG-2HL	DG-1HL

*Indicates contents of Repair Kit
 +Indicates contents of Diaphragm & Gasket Set

Carburetor Model		HL-299E	HL-231E	HL-232E
Customer				
Equipment Model No.				
Venturi				
Ref. No.	Part Name			
*3	Body Channel Welch Plug	179-55	179-55	179-55
4	Choke Friction Pin			206-121
4A	Choke Friction Pin	80-317		
5	Choke Friction Spring	24B-281		24B-281
6	Choke Shutter	27-309	171-647	27-311
7	Choke Shutter Screw			15B-307
8				
+*9	Diaphragm Gasket	16B-217	16B-217	16B-217
+10	Diaphragm	237-600	237-600	237-600
11	Diaphragm Cover	91A-250	91-757	91A-275
*12	Flange Gasket	16B-216	16B-216	16B-216
+*13	Fuel Pump Gasket	16B-223	16B-223	16B-223
+*14	Fuel Pump Diaphragm	237-214	237-214	237-214
15	Fuel Pump Body	141-55	141-55	141-62
16	Fuel Pump Body Screw (6)	15C-51	15C-51	15C-51
17	Fuel Strainer Screen	95-170		95-170
*18	Fuel Strainer Cover Gasket	16B-205	16B-205	16B-205
19	Fuel Strainer Cover	91A-251	91A-251	91A-251
20	Fuel Strainer Cover Retaining Screw	15B-313	15B-313	15B-313
21A	Idle Mixture Screw	43-388	43-995	43-388
21B	Idle Mixture Screw Spring	24B-449	24B-449	24B-449
21C	Idle Mixture Screw Washer	78A-256	78A-256	
21D	Idle Mixture Screw Packing	44-270	44-270	
23	Idle Speed Screw		15C-9	15C-9
24	Idle Speed Screw Spring	24B-131	24B-131	24B-131
*25	Inlet Control Lever	155A-27	155A-27	155A-27
26	Inlet Control Lever Fulcrum Screw	15B-329	15B-329	15B-329
26A	Inlet Control Lever Fulcrum Pin	32-79	32-79	32-79
*27	Inlet Needle, Seat & Gasket	233-677	233-665	233-677
28	Inlet Seat Gasket	16B-199	16B-199	16B-199
29	Inlet Tension Spring	24B-299	24B-299	24B-299
30A	High Speed Mixture Screw	43-967		43-967
30B	High Speed Mixture Screw Spring	24B-449		24B-449
30C	High Speed Mixture Screw Washer	78A-256		78A-256
30D	High Speed Mixture Screw Packing	44-270		44-270
31A	Nozzle Check Valve	363-501	363-501	363-501
32	Throttle Shaft Bushing (2)			
33	Throttle Shaft Clip	29-218	29-218	29-218
36	Throttle Shaft Return Spring	24B-291		24B-328
37	Throttle Shutter	14-407	14-407	14-407
38	Throttle Shutter Screw	15B-307		15B-307
A4	Throttle Shaft & Lever	13-1592	13-2033	13-1592
A12	Throttle Shaft & Lever		26-1012	
A15	Choke Shaft & Lever	26-977		26-1013
D11	Throttle Lever Ret. Nut	81-344		
D12	Main Fuel Jet Plug Screw		15B-287	
D15	Main Fuel Jet (.039)		49A-185	
D17	Main Fuel Jet Plug Screw Gasket		16B-225	
D17	Main Fuel Jet Gasket		16B-184	
D17	Choke Shaft Seal Washer		44-268	
D17	Choke Shaft Seal Washer		78A-249	
D17	Throttle Shaft Seal Washer		78A-249	
E1	Choke Shaft Return Spring		24B-325	
E6	Throttle Shaft Return Spring		24B-381	
	Repair Parts Kit	DG-2HL	RK-90HL	RK-102HL
	Diaphragm & Gasket Set	DG-2HL	DG-3HL	DG-1HL

*Indicates contents of Repair Kit
 +Indicates contents of Diaphragm & Gasket Set

Carburetor Model		HL-274E	HL-292G	HL-293F
Customer				
Equipment Model No.				
Venturi				
Ref. No.	Part Name			
2	Body Channel Cup Plug			80-160
*3	Body Channel Welch Plug	179-55	179-55	179-55
4	Choke Friction Pin	206-121		
5	Choke Friction Spring	24B-281		
6	Choke Shutter	27-311	27-296	
7	Choke Shutter Screw	15C-29	15C-29	
8				
+*9	Diaphragm Gasket	16B-217	16B-217	16B-217
+10	Diaphragm	237-600	237-600	237-600
11	Diaphragm Cover	91A-275	91A-250	91A-275
*12	Flange Gasket			
+*13	Fuel Pump Gasket	16B-223	16B-223	
+*14	Fuel Pump Diaphragm	237-214	237-214	237-214
15	Fuel Pump Body	141-62	141-55	141-62
16	Fuel Pump Body Screw (6)		15C-51	15C-51
17	Fuel Strainer Screen	95-170	95-170	95-174
*18	Fuel Strainer Cover Gasket	16B-205	16B-205	16B-205
19	Fuel Strainer Cover	91A-251	91A-251	
20	Fuel Strainer Cover Retaining Screw	15B-313	15B-313	15B-313
20A	Governor Valve Assembly	361-500	361-500	
20B	Governor Valve Assembly Gasket	16B-204	16B-204	
21	Idle Mixture Screw			
21A	Idle Mixture Screw	43-388	43-388	43-967
21B	Idle Mixture Screw Spring		24B-449	24B-449
21C	Idle Mixture Screw Washer	78A-256	78A-256	78A-256
21D	Idle Mixture Screw Packing	44-270	44-270	44-270
22	Idle Mixture Screw Seal Ring			
23	Idle Speed Screw	15C-9	15C-9	15C-9
24	Idle Speed Screw Spring	24B-131	24B-131	24B-131
*25	Inlet Control Lever	155A-27	155A-27	155A-23
26	Inlet Control Lever Fulcrum Screw	15B-329	15B-329	15B-329
26A	Inlet Control Lever Fulcrum Pin	32-79	32-79	32-79
*27	Inlet Needle, Seat & Gasket	233-665	233-664	233-665
28	Inlet Seat Gasket	16B-199	16B-199	16B-199
29	Inlet Tension Spring	24B-299	24B-323	
30	High Speed Mixture Screw			
30A	High Speed Mixture Screw	43-401		43-988
30B	High Speed Mixture Screw Spring	24B-449	24B-449	24B-449
30C	High Speed Mixture Screw Washer	78A-256	78A-256	78A-256
30D	High Speed Mixture Screw Packing	44-270		44-270
31				
31A	Nozzle Check Valve	363-501	363-501	
32	Throttle Shaft Bushing (2)			
33	Throttle Shaft Clip (2)	29-218	29-218	29-218
34	Throttle Shaft Clip Lockwasher			
35	Throttle Shaft Clip Ret. Screw			
36	Throttle Shaft Return Spring	24B-328	24B-291	24B-328
37	Throttle Shutter	14-407	14A-34	14-407
38	Throttle Shutter Screw	15C-29	15C-29	15B-307
39				
A4	Throttle Shaft & Lever	13-1656	13-1586	
A17	Choke Shaft & Lever	26-1036		
A32	Throttle Shaft & Lever			13-2024
B1	Choke Shaft			
B2	Choke Shaft		26-461	
C3	Throttle Lever		12-1167	
C9	Throttle Lever	12B-158		
	Repair Parts Kit	RK-90HL	RK-94HL	RK-83HL
	Diaphragm & Gasket Set	DG-3HL	DG-2HL	DG-2HL

*Indicates contents of Repair Kit

+Indicates contents of Diaphragm & Gasket Set

Carburetor Model		HL-292G	HL-293F	HL-299G
Customer				
Equipment Model No.				
Venturi				
Ref. No.	Part Name			
2	Body Channel Cup Plug		80-160	80-332
*3	Body Channel Welch Plug	179-55	179-55	179-55
4	Choke Friction Pin			206-121
5	Choke Friction Spring			24B-281
6	Choke Shutter	27-296		27-296
7	Choke Shutter Screw	15C-307		
8				
+*9	Diaphragm Gasket	16B-217	16B-217	16B-217
+10	Diaphragm	237-600	237-600	237-600
11	Diaphragm Cover	91A-250	91A-275	91A-250
*12	Flange Gasket	16B-206		16B-206
+*13	Fuel Pump Gasket	16B-223		16B-223
+*14	Fuel Pump Diaphragm	237-214	237-214	237-214
15	Fuel Pump Body	141-55	141-62	141-55
16	Fuel Pump Body Screw (6)	15C-51	15C-51	15C-51
17	Fuel Strainer Screen	95-170	95-174	95-170
*18	Fuel Strainer Cover Gasket	16B-205	16B-205	16B-205
19	Fuel Strainer Cover	91A-251	91A-351	91A-251
20	Fuel Strainer Cover Retaining Screw	15B-313	15B-313	15B-313
20A	Governor Valve Assembly	361-500		
20B	Governor Valve Assembly Gasket	16B-204		
21	Idle Mixture Screw			
21A	Idle Mixture Screw	43-388	43-967	43-388
21B	Idle Mixture Screw Spring	24B-449	24B-449	24B-449
21C	Idle Mixture Screw Washer	78A-256	78A-256	78A-256
21D	Idle Mixture Screw Packing	44-270	44-270	44-270
22	Idle Mixture Screw Seal Ring			
23	Idle Speed Screw	15C-9	15C-9	15C-9
24	Idle Speed Screw Spring	24B-131	24B-131	24B-131
*25	Inlet Control Lever	155A-27	155A-23	155A-27
26	Inlet Control Lever Fulcrum Screw	15B-329	15B-329	15B-329
26A	Inlet Control Lever Fulcrum Pin	32-79	32-79	32-79
*27	Inlet Needle, Seat & Gasket	233-664	233-665	233-703
28	Inlet Seat Gasket	16B-199	16B-199	16B-199
29	Inlet Tension Spring	24B-323		24B-299
30	High Speed Mixture Screw			
30A	High Speed Mixture Screw		43-988	24B-449
30B	High Speed Mixture Screw Spring	24B-449	24B-449	78A-256
30C	High Speed Mixture Screw Washer	78A-256	78A-256	44-270
30D	High Speed Mixture Screw Packing		44-270	
31				
31A	Nozzle Check Valve	363-501		
32	Throttle Shaft Bushing (2)			
33	Throttle Shaft Clip (2)	29-218	29-218	
34	Throttle Shaft Clip Lockwasher			29-218
35	Throttle Shaft Clip Ret. Screw			
36	Throttle Shaft Return Spring	24B-291	24B-328	24B-297
37	Throttle Shutter	14A-34	14-407	14-386
38	Throttle Shutter Screw	15C-29	15B-307	15C-29
39				
A4	Throttle Shaft & Lever	13-1586		13-1592
A15	Choke Shaft & Lever			26-990
A32	Throttle Shaft & Lever		13-2024	
B2	Choke Shaft	26-461		
C3	Throttle Lever	12-1167		
	Repair Parts Kit	RK-94HL	RK-83HL	RK-92HL
	Diaphragm & Gasket Set	DG-2HL	DG-2HL	DG-2HL

*Indicates contents of Repair Kit

+Indicates contents of Diaphragm & Gasket Set

Carburetor Model		HL-304E	HL-324A	HL-334A
Customer				
Equipment Model No.				
Venturi				
Ref. No.	Part Name			
2	Body Channel Cup Plug			
*3	Body Channel Welch Plug	179-55	179-55	179-55
6	Choke Shutter		27-309	
7	Choke Shutter Screw			
8				
+*9	Diaphragm Gasket	16B-217	16B-217	16B-217
+10	Diaphragm	237-600	237-600	237-600
11	Diaphragm Cover	91A-275	91A-275	91A-275
*12	Flange Gasket	16B-216	16B-216	16B-216
+*13	Fuel Pump Gasket	16B-223	16B-223	16B-223
+*14	Fuel Pump Diaphragm	237-141	237-141	237-141
15	Fuel Pump Body	141-89	141-62	141-89
16	Fuel Pump Body Screw (6)	15C-51		15C-51
17	Fuel Strainer Screen	95-170	95-170	95-170
*18	Fuel Strainer Cover Gasket	16B-205	16B-205	16B-205
19	Fuel Strainer Cover	91A-251	91A-251	91A-351
20	Fuel Strainer Cover Retaining Screw	15B-313	15B-313	15B-313
20A	Governor Valve Assembly			
20B	Governor Valve Assembly Gasket			
21	Idle Mixture Screw			
21A	Idle Mixture Screw	43-388	43-388	43-388
21B	Idle Mixture Screw Spring	24B-449	24B-449	24B-449
21C	Idle Mixture Screw Washer	78A-256	78A-256	78A-256
21D	Idle Mixture Screw Packing	44-270	44-270	44-270
22	Idle Mixture Screw Seal Ring			
23	Idle Speed Screw	15C-9	15C-9	15C-9
24	Idle Speed Screw Spring	24B-131	24B-131	24B-131
*25	Inlet Control Lever	155A-27	155A-27	155A-27
26	Inlet Control Lever Fulcrum Screw	15B-329	15B-329	15B-329
26A	Inlet Control Lever Fulcrum Pin	32-79	32-79	32-79
*27	Inlet Needle, Seat & Gasket	233-665	233-667	233-710
*27	Alternative Needle, Seat & Gasket (Nickel Plated Seat)		233-707	
28	Inlet Seat Gasket	16B-199	16B-199	16B-199
29	Inlet Tension Spring	24B-299	24B-299	24B-323
30	High Speed Mixture Screw			
30A	High Speed Mixture Screw	43-967	43-401	43-967
30B	High Speed Mixture Screw Spring	24B-449	24B-449	24B-449
30C	High Speed Mixture Screw Washer	78A-256	78A-256	78A-256
30D	High Speed Mixture Screw Packing	44-270	44-270	44-270
31				
31A	Nozzle Check Valve	363-503	363-501	363-503
32	Throttle Shaft Bushing (2)			
33	Throttle Shaft Clip		29-218	29-224
34	Throttle Shaft Clip Lockwasher			
35	Throttle Shaft Clip Ret. Screw		15C-18	15C-19
36	Throttle Shaft Return Spring	24B-381	24B-328	24B-381
37	Throttle Shutter	14-407	14-407	14-407
38	Throttle Shutter Screw	15C-29		15C-29
39				
A4	Throttle Shaft & Lever		13-1639	
A30	Choke Shaft & Lever		26-1020	
A31	Throttle Shaft & Lever			
A32	Throttle Shaft & Lever	13-2034		13-1894
D13	Throttle Lever Ret. Screw		15C-18	
	Repair Parts Kit	RK-102HL	RK-94HL	RK-117HL
	Diaphragm & Gasket Set	DG-1HL	DG-2HL	DG-1HL

*Indicates contents of Repair Kit

+Indicates contents of Diaphragm & Gasket Set

Carburetor Model		HL-363C	HL-366A	HL-371A
Customer			Andreas Stihl	Andreas Stihl
Equipment Model No.				
Venturi				
Ref. No.	Part Name			
*3	Body Channel Welch Plug	179-57	179-55	179-55
	Choke Lever		25-696	25-696
6	Choke Shutter		27-296	27-376
7	Choke Shutter Screw		15C-29	15C-29
8				
+*9	Diaphragm Gasket	16B-217	16B-217	16B-217
+10	Diaphragm	237-600	237-600	237-600
11	Diaphragm Cover	91A-303	91A-250	91A-267
*12	Flange Gasket	16B-216	16B-206	16B-206
+*13	Fuel Pump Gasket	16B-252	16B-223	16B-223
+*14	Fuel Pump Diaphragm	237-154	237-214	237-214
15	Fuel Pump Body	198-305	141-55	141-55
16	Fuel Pump Body Screw (6)		15C-51	15C-51
17	Fuel Strainer Screen	95-174	95-170	95-170
*18	Fuel Strainer Cover Gasket	16B-205	16B-205	16B-205
19	Fuel Strainer Cover	91A-351	91A-251	91A-251
20	Fuel Strainer Cover Retaining Screw	15B-313	15B-313	15B-313
20A	Governor Valve Assembly		361-500	361-500
20B	Governor Valve Assembly Gasket		16B-204	16B-204
21	Idle Mixture Screw			
21A	Idle Mixture Screw	43-967	43A-193	43A-193
21B	Idle Mixture Screw Spring	24B-449	24C-273	24C-273
21C	Idle Mixture Screw Washer	78A-256		
21D	Idle Mixture Screw Packing	44-270	44-270	44-270
22	Idle Mixture Screw Seal Ring			
23	Idle Speed Screw		15C-9	15C-9
24	Idle Speed Screw Spring		24B-131	24B-131
*25	Inlet Control Lever	155A-23	155A-27	155A-27
26	Inlet Control Lever Fulcrum Screw	15B-329	15B-329	15B-329
26A	Inlet Control Lever Fulcrum Pin	32-79	32-79	32-79
*27	Inlet Needle, Seat & Gasket		233-706	233-706
*27	Alternative Needle, Seat & Gasket (Nickel Plated Seat)		233-664	233-664
28	Inlet Seat Gasket	16B-199	16B-199	16B-199
29	Inlet Tension Spring	24B-323	24B-323	24B-323
29A	Inlet Valve Body	67-38		
29B	Inlet Valve Body Screw (6)	15B-343		
29C	Inlet Valve Diaphragm	237-155		
29D	Inlet Valve Gasket	16B-253		
30A	High Speed Mixture Screw	43-988	43A-192	43A-192
30B	High Speed Mixture Screw Spring	24B-449	24C-273	24C-273
30C	High Speed Mixture Screw Washer	78A-256		
30D	High Speed Mixture Screw Packing	44-270	44-270	44-270
31				
31A	Nozzle Check Valve	363-118	363-640	363-649
33	Throttle Shaft Clip (2)		29-218	29-218
34	Throttle Shaft Clip Lockwasher	29-220		
35	Throttle Shaft Clip Ret. Screw (2)		15C-18	15C-18
36	Throttle Shaft Return Spring	24B-291	24B-291	24B-291
37	Throttle Shutter	14A-5	14A-34	14A-34
38	Throttle Shutter Screw	15C-29	15C-29	15C-29
39				
A4	Throttle Shaft & Lever	13-2102	13-1586	13-1586
D13	Throttle Lever Ret. Screw		15C-52	15C-52
D17	Fuel Strainer Cover Ret. Screw Gasket	78A-245		
B2	Choke Shaft		26-461	26-461
C1	Throttle Lever		12-1167	
E1	Choke Shaft Return Spring		24C-262	24C-262
E2	Choke Shaft Return Spring			
	Adjust Limiter Plug (2)		80-394	80-394
	Adjust Limiter Module		198-404	198-404
	Adjust Limiter Ring (Low Speed)		318-33	318-33
	Adjustment Limiter Ring (High Speed)		318-34	318-34
	Repair Parts Kit	RK-104HL	RK-114HL	RK-114HL
	Diaphragm & Gasket Set	DG-4HL/R	DG-5HL	DG-5HL

*Indicates contents of Repair Kit

+Indicates contents of Diaphragm & Gasket Set

Carburetor Model		HL-375A	
Customer			
Equipment Model No.			
Venturi			
Ref. No.	Part Name		
2	Body Channel Cup Plug		
*3	Body Channel Welch Plug	179-63	
4	Choke Friction Pin		
4A	Choke Friction Pin		
5	Choke Friction Spring		
6	Choke Shutter		
7	Choke Shutter Screw		
8			
+*9	Diaphragm Gasket	16B-217	
+10	Diaphragm	237-600	
11	Diaphragm Cover	91-1013	
*12	Flange Gasket		
+*13	Fuel Pump Gasket	16B-223	
+*14	Fuel Pump Diaphragm	237-141	
15	Fuel Pump Body	141-92	
16	Fuel Pump Body Screw (6)	15C-51	
17	Fuel Strainer Screen	95-170	
*18	Fuel Strainer Cover Gasket	16B-205	
19	Fuel Strainer Cover	91A-351	
20	Fuel Strainer Cover Retaining Screw	15B-313	
20A	Governor Valve Assembly		
20B	Governor Valve Assembly Gasket		
21	Idle Mixture Screw		
21A	Idle Mixture Screw	43-388	
21B	Idle Mixture Screw Spring	24B-449	
21C	Idle Mixture Screw Washer	78A-256	
21D	Idle Mixture Screw Packing	44-270	
22	Idle Mixture Screw Seal Ring		
23	Idle Speed Screw	15C-9	
24	Idle Speed Screw Spring	24B-131	
*25	Inlet Control Lever	155A-27	
26	Inlet Control Lever Fulcrum Screw	15B-329	
26A	Inlet Control Lever Fulcrum Pin	32-79	
*27	Inlet Needle, Seat & Gasket	233-665	
*27	Alternative Needle, Seat & Gasket (Nickel Plated Seat)		
28	Inlet Seat Gasket	16B-199	
29	Inlet Tension Spring	24B-323	
30	High Speed Mixture Screw	43-967	
30A	High Speed Mixture Screw		
30B	High Speed Mixture Screw Spring	24B-449	
30C	High Speed Mixture Screw Washer	78A-256	
30D	High Speed Mixture Screw Packing	44-270	
33	Throttle Shaft Clip	29-224	
34	Throttle Shaft Clip Lockwasher		
35	Throttle Shaft Clip Ret. Screw	15C-19	
36	Throttle Shaft Return Spring	24B-381	
37	Throttle Shutter	14A-2	
38	Throttle Shutter Screw	15C-20	
39			
A32	Throttle Shaft & Lever	13-1894	
D17	Fuel Strainer Cover Ret. Screw Gasket	78A-245	
	Repair Parts Kit	RK-117HL	
	Diaphragm & Gasket Set	DG-1HL	

*Indicates contents of Repair Kit

+Indicates contents of Diaphragm & Gasket Set